



Level 2

A space to bond and connect

- 1 Private Dining Room
- 2 Landscaped Garden
- 3 Private Lounge
- 4 Residents' Clubhouse
- 5 Multi-Purpose Room
- 6 Gymnasium
- 7 Concierge Counter



Level 3

A space to unwind and get together

- 1 Putting Green
- 2 Wellness Sanctuary
- 3 Teppanyaki Terrace
- 4 BBQ Terrace
- 5 Male and Female Changing Rooms with Sauna and Steam Rooms
- 6 Pavilion
- 7 Aquatic Gym Pool
- 8 Jacuzzi
- 9 Pool Deck
- 10 Relaxation Cabana
- 11 50m. Lap Pool
- 12 Family Pool
- 13 Children's Pool
- 14 Party Zone
- 15 Children's Play Area
- 16 Outdoor Fitness Area



1-Bedroom

Type 1A

64 sq.m. / 689 sq.ft. to 71 sq.m. / 764 sq.ft.
(including balcony of 6 sq.m. / 65 sq.ft. to 13 sq.m. / 140 sq.ft.)

TABULATION

Unit	Balcony Area		Floor Area	
	sq.m.	sq.ft.	sq.m.	sq.ft.
#18-03, #19-03	6	65	64	689
#04-03, #17-03, #20-03, #21-03	7	75	65	700
#16-03, #22-03	8	86	66	710
#05-03	9	97	67	721
#06-03, #07-03, #08-03, #15-03, #23-03	10	108	68	732
#09-03, #14-03, #24-03, #32-03	11	118	69	743
#10-03, #13-03, #25-03, #31-03	12	129	70	753
#11-03, #12-03, #26-03, #27-03, #28-03, #29-03, #30-03	13	140	71	764

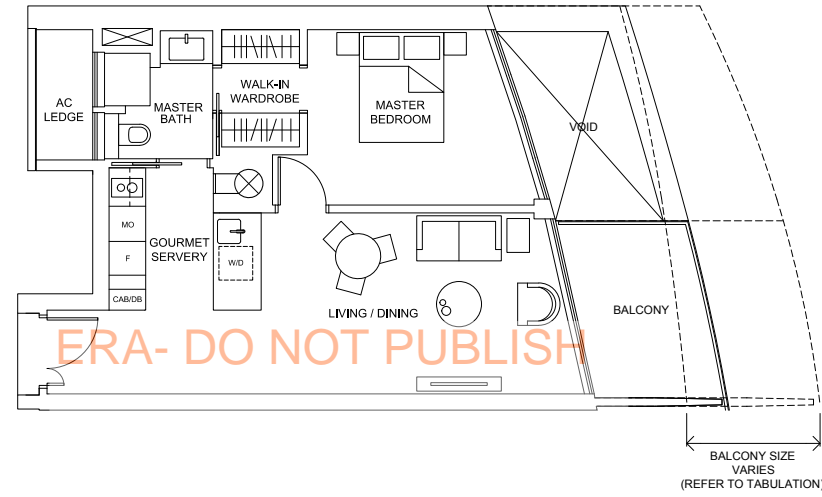
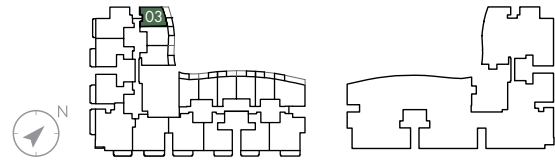

1-Bedroom

Type 1C

65 sq.m. / 700 sq.ft. to 66 sq.m. / 710 sq.ft.
(including balcony of 8 sq.m. / 86 sq.ft. to 9 sq.m. / 97 sq.ft.)

TABULATION

Unit	Balcony Area		Floor Area	
	sq.m.	sq.ft.	sq.m.	sq.ft.
#04-05, #05-05, #16-05, #17-05, #18-05, #19-05, #20-05, #21-05	8	86	65	700
#06-05, #07-05, #08-05, #09-05, #10-05, #11-05, #12-05, #13-05, #14-05, #15-05, #22-05, #23-05, #24-05, #25-05, #26-05, #27-05, #28-05, #29-05, #30-05, #31-05, #32-05	9	97	66	710

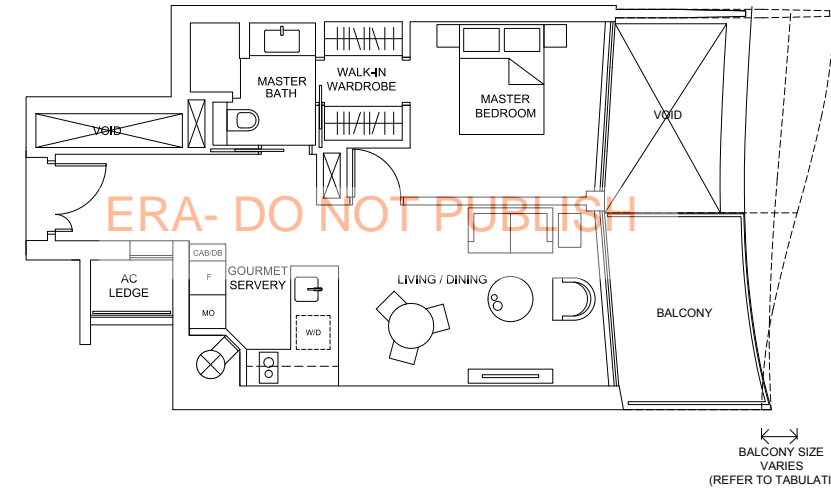
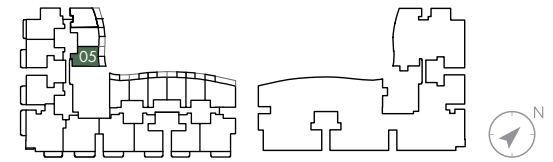

Type 1B

65 sq.m. / 700 sq.ft. to 72 sq.m. / 775 sq.ft.
(including balcony of 6 sq.m. / 65 sq.ft. to 13 sq.m. / 140 sq.ft.)

TABULATION

Unit	Balcony Area		Floor Area	
	sq.m.	sq.ft.	sq.m.	sq.ft.
#18-04, #19-04, #20-04	6	65	65	700
#17-04, #21-04	7	75	66	710
#04-04, #16-04, #22-04	8	86	67	721
#05-04, #23-04	9	97	68	732
#06-04, #15-04	10	108	69	743
#07-04, #08-04, #14-04, #24-04	11	118	70	753
#09-04, #13-04, #25-04, #26-04, #32-04	12	129	71	764
#10-04, #11-04, #12-04, #27-04, #28-04, #29-04, #30-04, #31-04	13	140	72	775

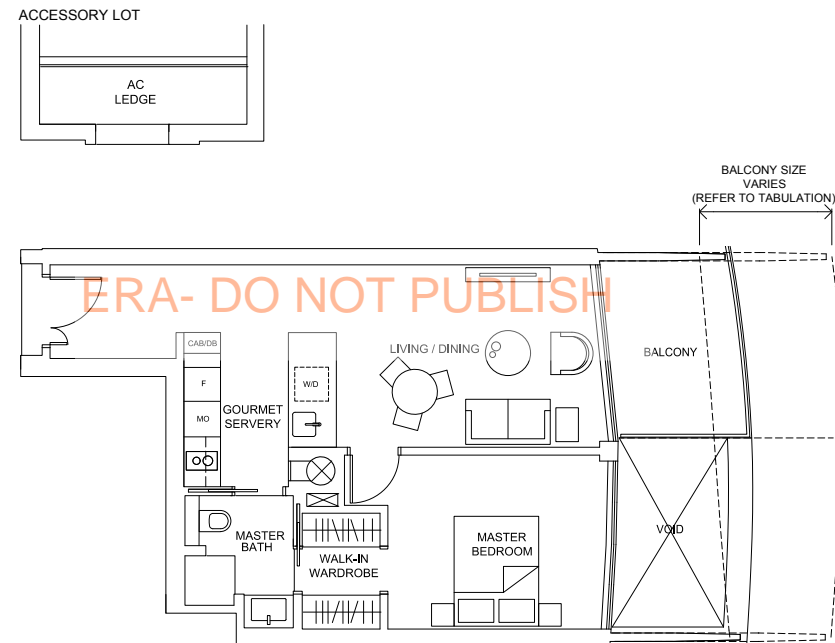
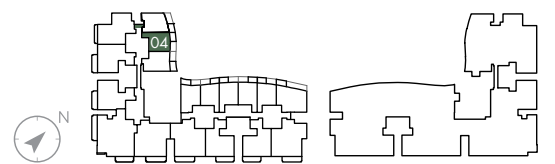

Type 1D

63 sq.m. / 678 sq.ft. to 66 sq.m. / 710 sq.ft.
(including balcony of 6 sq.m. / 65 sq.ft. to 9 sq.m. / 97 sq.ft.)

TABULATION

Unit	Balcony Area		Floor Area	
	sq.m.	sq.ft.	sq.m.	sq.ft.
#12-09, #13-09, #14-09	6	65	63	678
#04-09, #11-09, #15-09, #16-09, #30-09, #31-09	7	75	64	689
#05-09, #06-09, #08-09, #09-09, #10-09, #17-09, #18-09, #19-09, #20-09, #21-09, #22-09, #23-09, #24-09, #25-09, #26-09, #27-09, #28-09, #29-09	8	86	65	700
#07-09	9	97	66	710

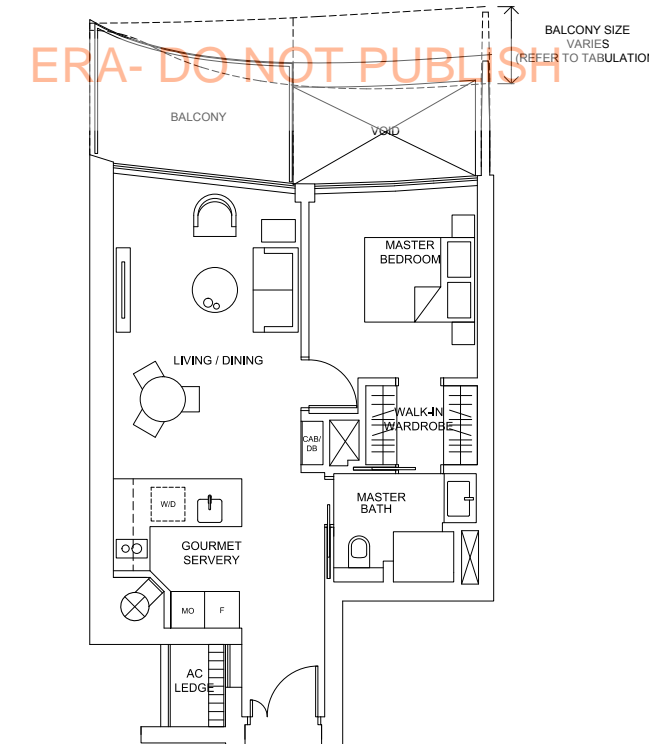
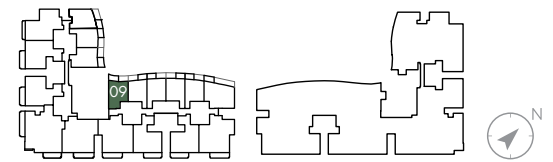

1-Bedroom

Type 1E

64 sq.m. / 689 sq.ft. to 68 sq.m. / 732 sq.ft.
(including balcony of 5 sq.m. / 54 sq.ft. to 9 sq.m. / 97 sq.ft.)

TABULATION

Unit	Balcony Area		Floor Area	
	sq.m.	sq.ft.	sq.m.	sq.ft.
#10-10, #11-10, #12-10	5	54	64	689
#09-10, #13-10, #14-10, #23-10, #24-10, #25-10, #26-10, #27-10, #28-10	6	65	65	700
#04-10, #08-10, #15-10, #16-10, #21-10, #22-10, #29-10	7	75	66	710
#05-10, #17-10, #18-10, #19-10, #20-10, #30-10, #31-10	8	86	67	721
#06-10, #07-10	9	97	68	732

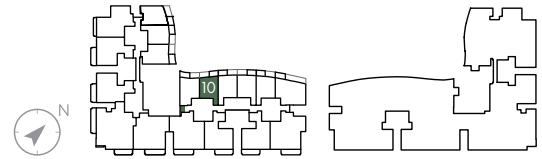

ACCESSORY LOT

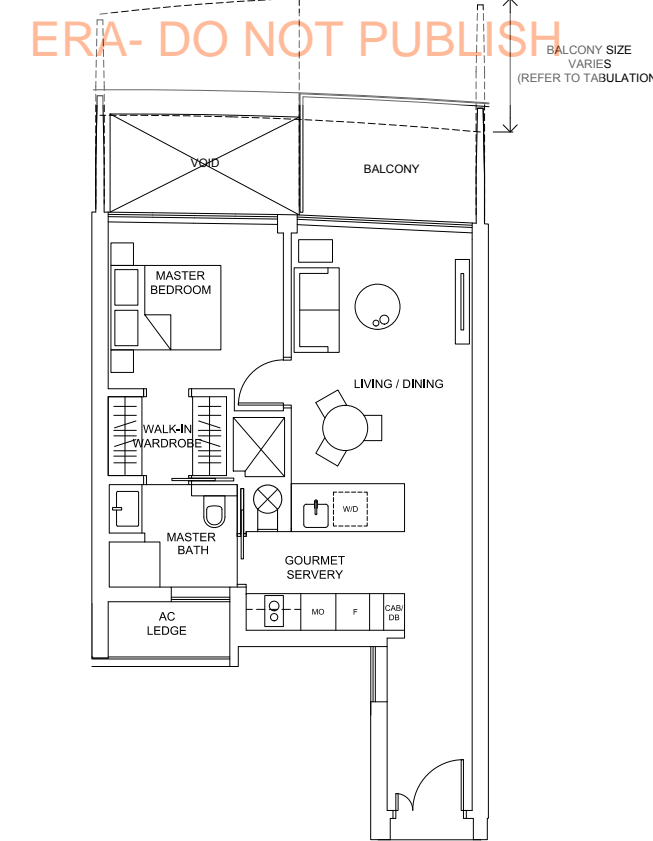
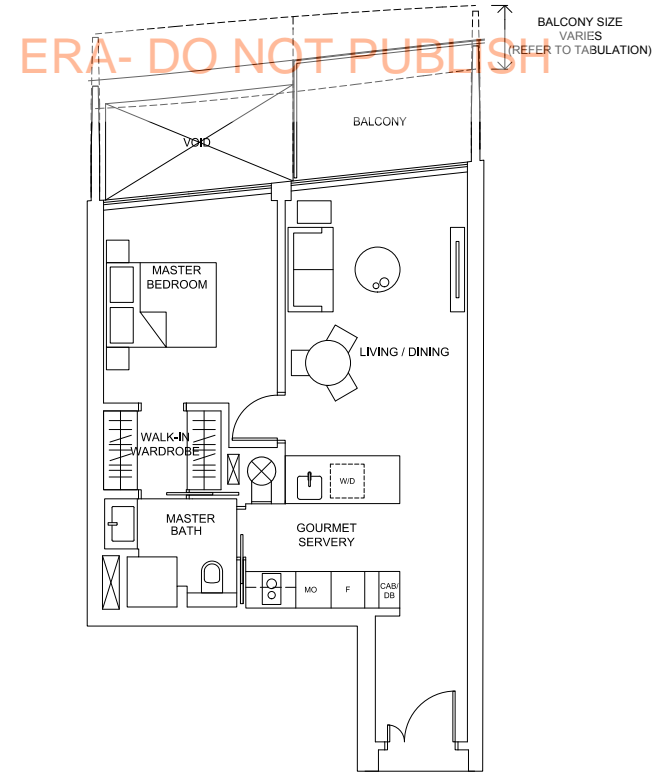
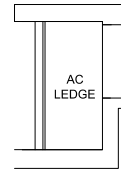

1-Bedroom

Type 1G

61 sq.m. / 657 sq.ft. to 69 sq.m. / 743 sq.ft.
(including balcony of 5 sq.m. / 54 sq.ft. to 13 sq.m. / 140 sq.ft.)

TABULATION

Unit	Balcony Area		Floor Area	
	sq.m.	sq.ft.	sq.m.	sq.ft.
#09-12	5	54	61	657
#08-12, #10-12, #11-12	6	65	62	667
#04-12, #05-12, #07-12, #12-12	7	75	63	678
#06-12, #13-12, #24-12, #25-12, #26-12, #27-12	8	86	64	689
#14-12, #23-12, #28-12	9	97	65	700
#15-12, #22-12, #29-12	10	108	66	710
#16-12, #21-12, #30-12	11	118	67	721
#17-12, #18-12, #19-12, #20-12, #31-12	12	129	68	732
#32-12	13	140	69	743

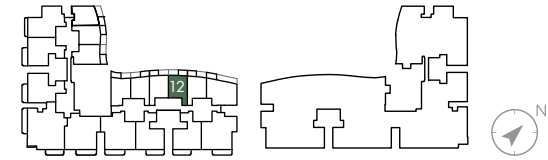

Type 1F

61 sq.m. / 657 sq.ft. to 65 sq.m. / 700 sq.ft.
(including balcony of 5 sq.m. / 54 sq.ft. to 9 sq.m. / 97 sq.ft.)

TABULATION

Unit	Balcony Area		Floor Area	
	sq.m.	sq.ft.	sq.m.	sq.ft.
#09-11, #10-11, #11-11, #25-11	5	54	61	657
#08-11, #12-11, #13-11, #23-11, #24-11, #26-11, #27-11	6	65	62	667
#04-11, #14-11, #22-11, #28-11, #29-11	7	75	63	678
#05-11, #06-11, #07-11, #15-11, #16-11, #20-11, #21-11, #30-11	8	86	64	689
#17-11, #18-11, #19-11, #31-11	9	97	65	700

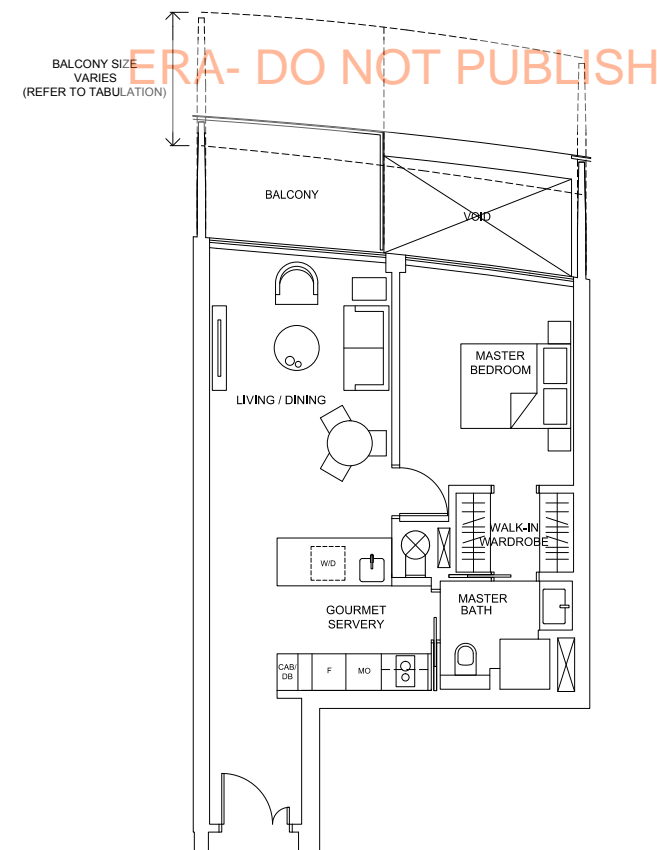
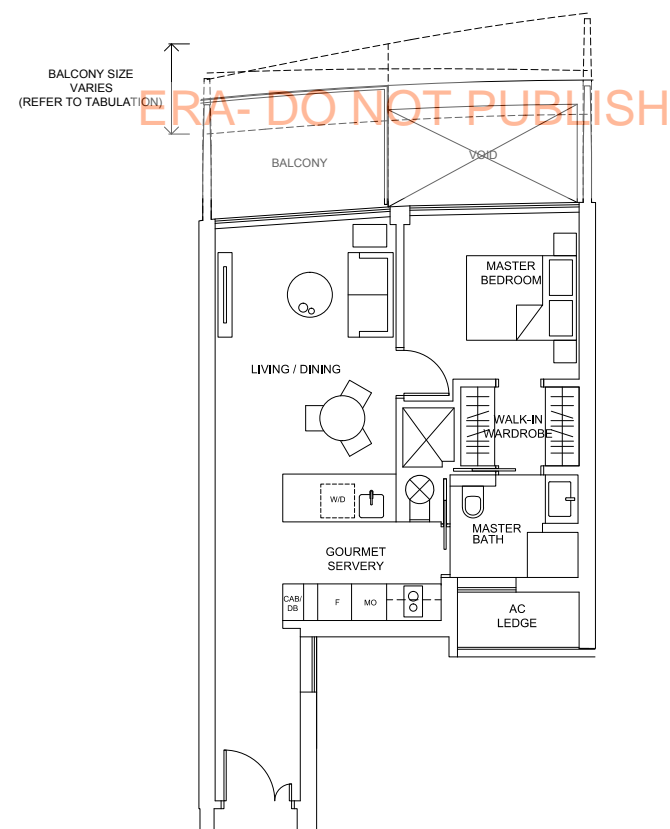
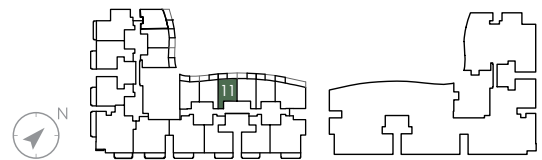

ACCESSORY LOT

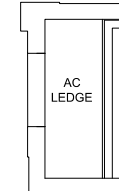

Type 1H

64 sq.m. / 689 sq.ft. to 72 sq.m. / 775 sq.ft.
(including balcony of 5 sq.m. / 54 sq.ft. to 13 sq.m. / 140 sq.ft.)

TABULATION

Unit	Balcony Area		Floor Area	
	sq.m.	sq.ft.	sq.m.	sq.ft.
#09-13, #10-13	5	54	64	689
#08-13, #11-13	6	65	65	700
#04-13, #07-13, #12-13	7	75	66	710
#05-13, #06-13, #13-13, #25-13, #26-13	8	86	67	721
#14-13, #24-13, #27-13	9	97	68	732
#23-13, #28-13	10	108	69	743
#15-13, #22-13, #29-13	11	118	70	753
#16-13, #20-13, #21-13, #30-13, #31-13	12	129	71	764
#17-13, #18-13, #19-13, #32-13	13	140	72	775

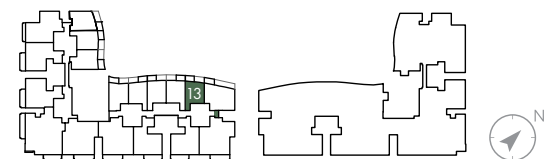

2-Bedroom

Type 2A

90 sq.m. / 969 sq.ft. to 99 sq.m. / 1,066 sq.ft.
(including balcony of 6 sq.m. / 65 sq.ft. to 15 sq.m. / 161 sq.ft.)

TABULATION

Unit	Balcony Area		Floor Area	
	sq.m.	sq.ft.	sq.m.	sq.ft.
#09-14, #10-14	6	65	90	969
#08-14, #11-14	7	75	91	980
#12-14	8	86	92	990
#04-14, #05-14, #07-14, #13-14	9	97	93	1,001
#06-14, #14-14, #24-14, #25-14, #26-14, #27-14	10	108	94	1,012
#23-14, #28-14	11	118	95	1,023
#15-14, #22-14, #29-14, #30-14	12	129	96	1,033
#16-14, #21-14, #31-14, #32-14	13	140	97	1,044
#17-14, #20-14	14	151	98	1,055
#18-14, #19-14	15	161	99	1,066

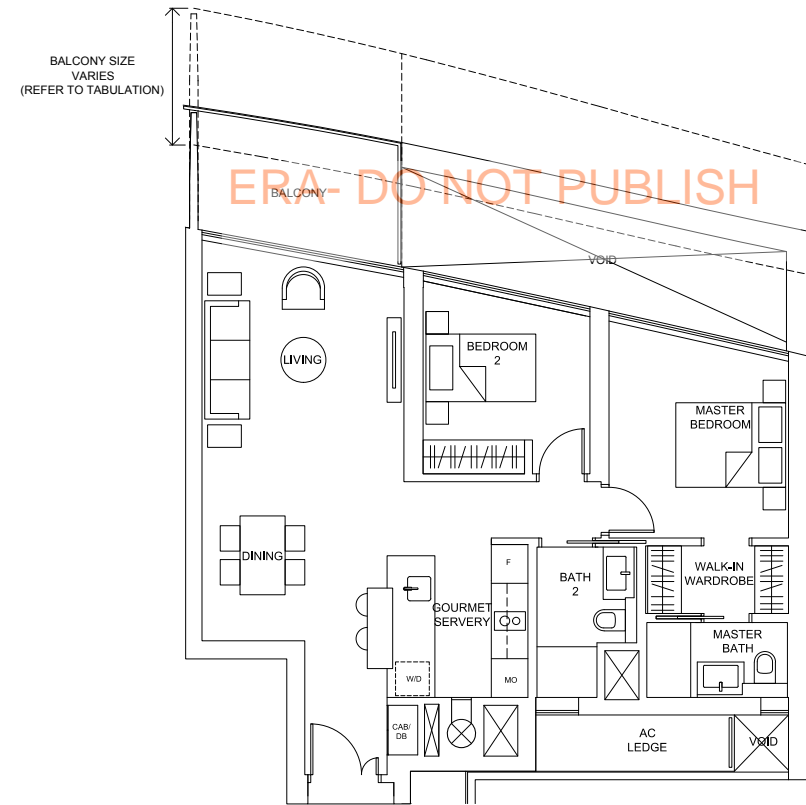
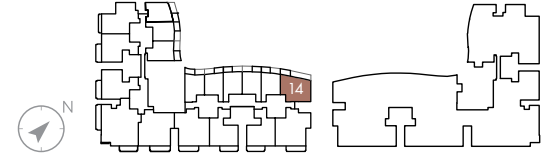

Outline of Roof Above
#08-06, #16-06,
#23-06, #30-06

Balcony Configuration A

Outline of Roof Above
#06-06, #12-06,
#20-06, #26-06

Balcony Configuration B

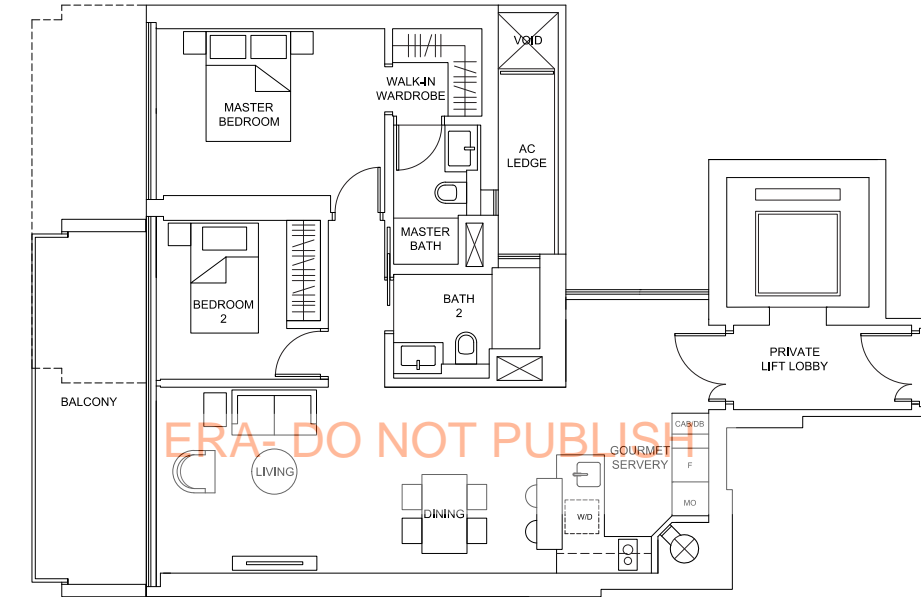

2-Bedroom

Type 2D

104 sq.m. / 1,119 sq.ft.
(including balcony of 13 sq.m. / 140 sq.ft.)

TABULATION

Unit	Balcony Area		Floor Area		Configuration
	sq.m.	sq.ft.	sq.m.	sq.ft.	
#07-06, #08-06, #13-06, #14-06, #15-06, #16-06, #21-06, #22-06, #23-06, #27-06, #28-06, #29-06, #30-06	13	140	104	1,119	A
#04-06, #05-06, #06-06, #09-06, #10-06, #11-06, #12-06, #17-06, #18-06, #19-06, #20-06, #24-06, #25-06, #26-06, #31-06, #32-06	13	140	104	1,119	B

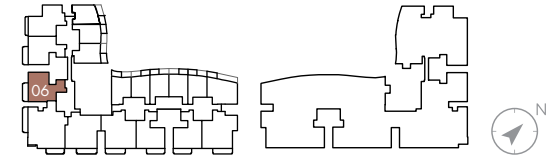

Type 2C

104 sq.m. / 1,119 sq.ft. to 105 sq.m. / 1,130 sq.ft.
(including balcony of 12 sq.m. / 129 sq.ft. to 13 sq.m. / 140 sq.ft.)

TABULATION

Unit	Balcony Area		Floor Area		Configuration
	sq.m.	sq.ft.	sq.m.	sq.ft.	
#07-01, #08-01, #09-01, #10-01, #13-01, #14-01, #15-01, #16-01, #20-01, #21-01, #22-01, #27-01, #28-01	12	129	104	1,119	A
#04-01, #05-01, #06-01, #11-01, #12-01, #17-01, #18-01, #19-01, #23-01, #24-01, #25-01, #26-01, #29-01, #30-01, #31-01, #32-01	13	140	105	1,130	B

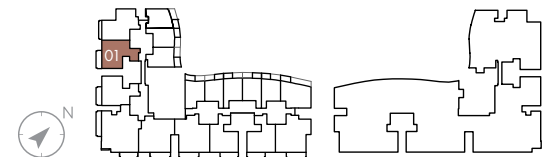

Outline of Roof Above
#10-01, #16-01,
#22-01, #28-01

Balcony Configuration A

Outline of Roof Above
#06-01, #12-01,
#19-01, #26-01

Balcony Configuration B

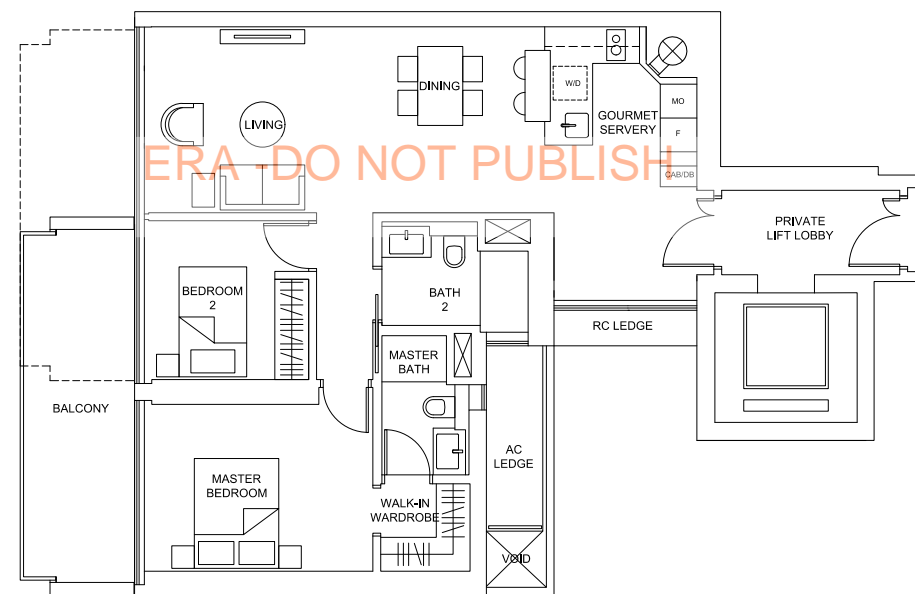

Outline of Roof Above
#07-17, #12-17,
#19-17, #25-17,
#30-17

Balcony Configuration A

Outline of Roof Above
#05-17, #09-17,
#15-17, #22-17,
#27-17

Balcony Configuration B

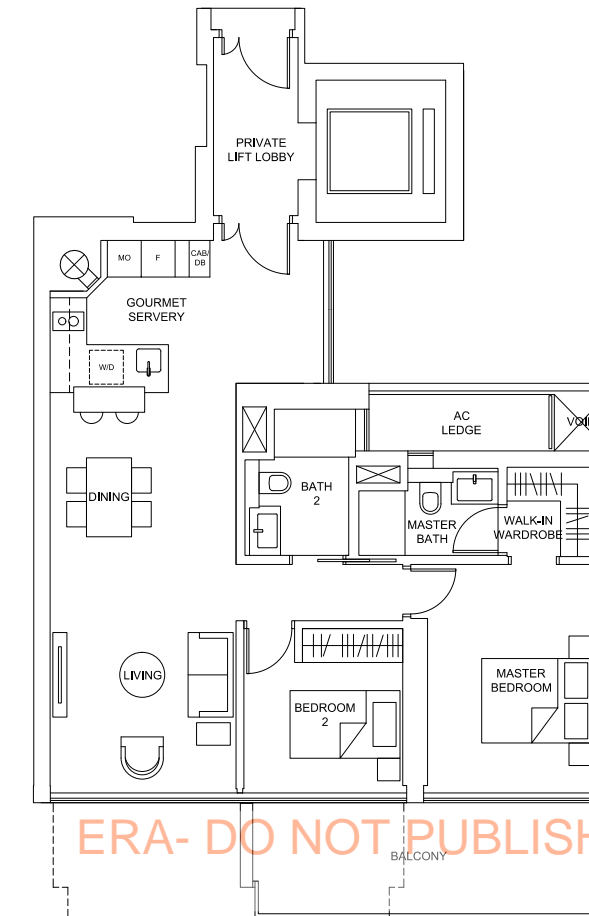

Type 2E

103 sq.m. / 1,109 sq.ft. to 104 sq.m. / 1,119 sq.ft.
(including balcony of 12 sq.m. / 129 sq.ft. to 13 sq.m. / 140 sq.ft.)

TABULATION

Unit	Balcony Area		Floor Area		Configuration
	sq.m.	sq.ft.	sq.m.	sq.ft.	
#06-17, #07-17, #10-17, #11-17, #12-17, #16-17, #17-17, #18-17, #19-17, #23-17, #24-17, #25-17, #28-17, #29-17, #30-17	12	129	103	1,109	A
#04-17, #05-17, #08-17, #09-17, #13-17, #14-17, #15-17, #20-17, #21-17, #22-17, #26-17, #27-17, #31-17	13	140	104	1,119	B

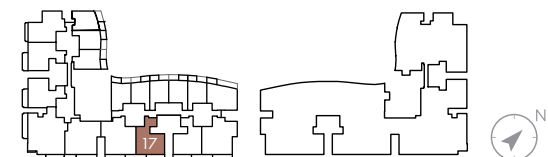

2-Bedroom

Type 2F

103 sq.m. / 1,109 sq.ft. to 104 sq.m. / 1,119 sq.ft.
(including balcony of 12 sq.m. / 129 sq.ft. to 13 sq.m. / 140 sq.ft.)

TABULATION

Unit	Balcony Area		Floor Area		Configuration
	sq.m.	sq.ft.	sq.m.	sq.ft.	
#08-16, #09-16, #10-16, #11-16, #16-16, #17-16, #18-16, #19-16, #22-16, #23-16, #24-16, #25-16, #29-16, #30-16, #31-16	12	129	103	1,109	A
#04-16, #05-16, #06-16, #07-16, #12-16, #13-16, #14-16, #15-16, #20-16, #21-16, #26-16, #27-16, #28-16, #32-16	13	140	104	1,119	B

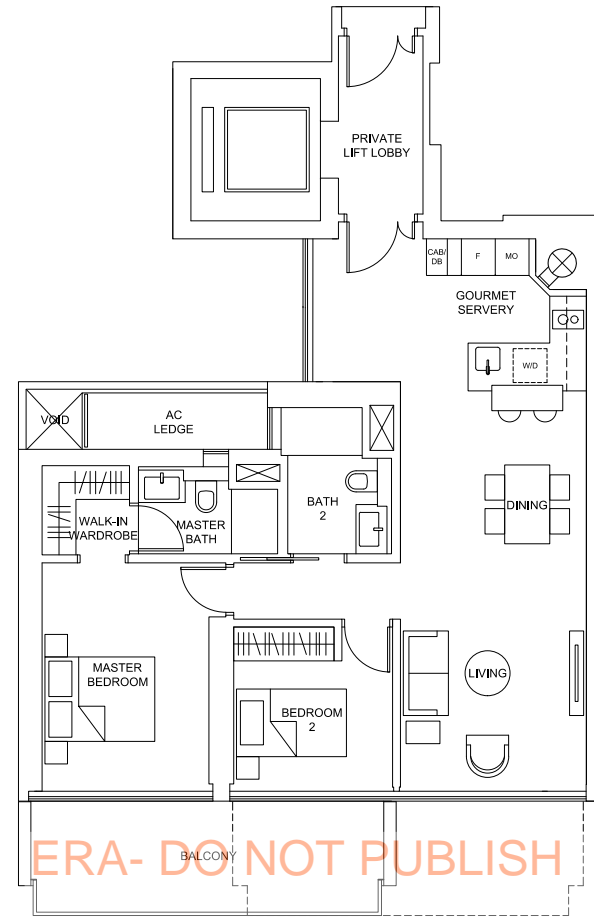
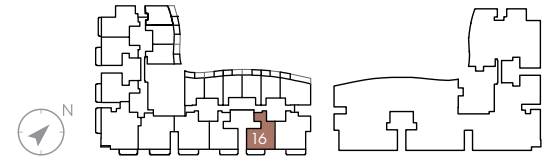

Outline of Roof Above
#11-16, #19-16,
#25-16, #31-16

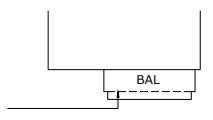

Balcony Configuration A

Outline of Roof Above
#07-16, #15-16,
#21-16, #28-16

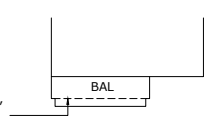

Balcony Configuration B

2-Bedroom + study

Type 2B + S

106 sq.m. / 1,141 sq.ft. to 113 sq.m. / 1,216 sq.ft.
(including balcony of 7 sq.m. / 75 sq.ft. to 14 sq.m. / 151 sq.ft.)

TABULATION

Unit	Balcony Area		Floor Area		Configuration
	sq.m.	sq.ft.	sq.m.	sq.ft.	
#06-02, #07-02, #08-02, #09-02, #10-02, #14-02, #15-02, #16-02, #21-02, #22-02, #23-02, #28-02, #29-02	7	75	106	1,141	A
#04-02, #05-02, #11-02, #12-02, #13-02, #17-02, #18-02, #19-02, #20-02, #24-02, #25-02, #26-02, #30-02, #31-02, #32-02	7	75	106	1,141	B
#27-02	14	151	113	1,216	C

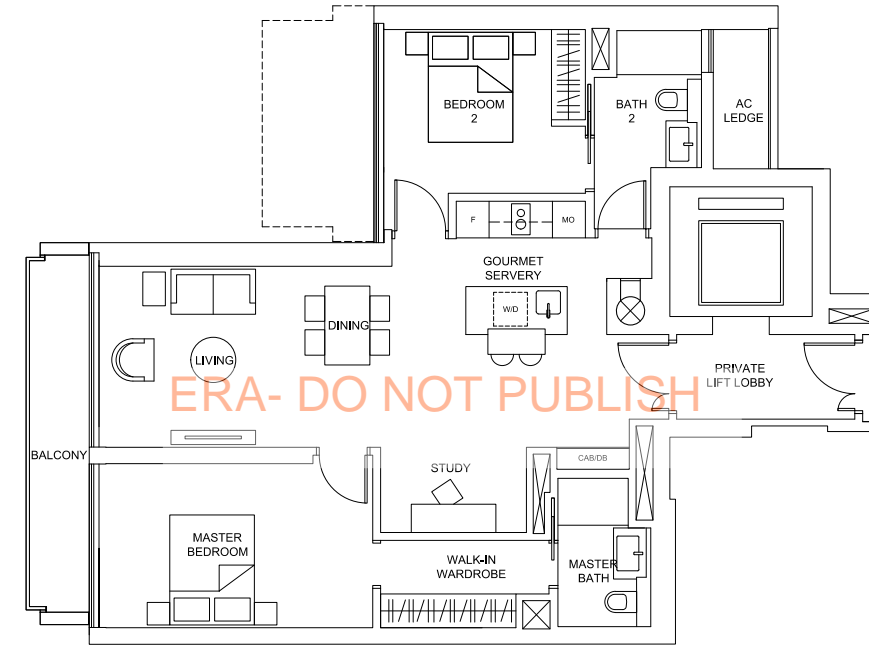
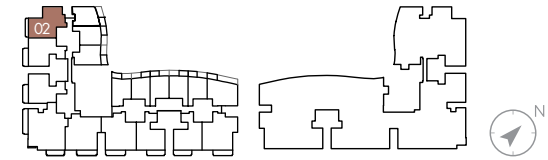

Outline of Roof Above
#10-02, #16-02,
#23-02, #29-02

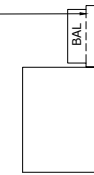

Balcony Configuration A

Outline of Roof Above
#05-02, #13-02,
#20-02

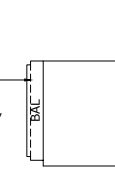

Balcony Configuration B

Outline of Roof Above
#27-02

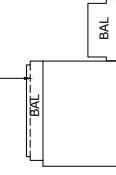

Balcony Configuration C

3-Bedroom

Type 3A

141 sq.m. / 1,518 sq.ft. to 143 sq.m. / 1,539 sq.ft.
(including balcony of 12 sq.m. / 129 sq.ft. to 14 sq.m. / 151 sq.ft.)

TABULATION

Unit	Balcony Area		Floor Area		Configuration
	sq.m.	sq.ft.	sq.m.	sq.ft.	
#09-07, #10-07, #11-07, #15-07, #16-07, #17-07, #18-07, #21-07, #22-07, #23-07, #26-07, #27-07, #28-07, #29-07	12	129	141	1,518	A
#04-07, #05-07, #06-07, #07-07, #08-07, #12-07, #13-07, #14-07, #19-07, #20-07, #24-07, #25-07, #30-07, #31-07, #32-07	14	151	143	1,539	B

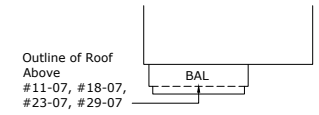
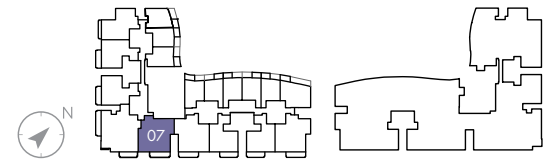

Balcony Configuration A

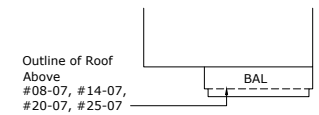

Balcony Configuration B

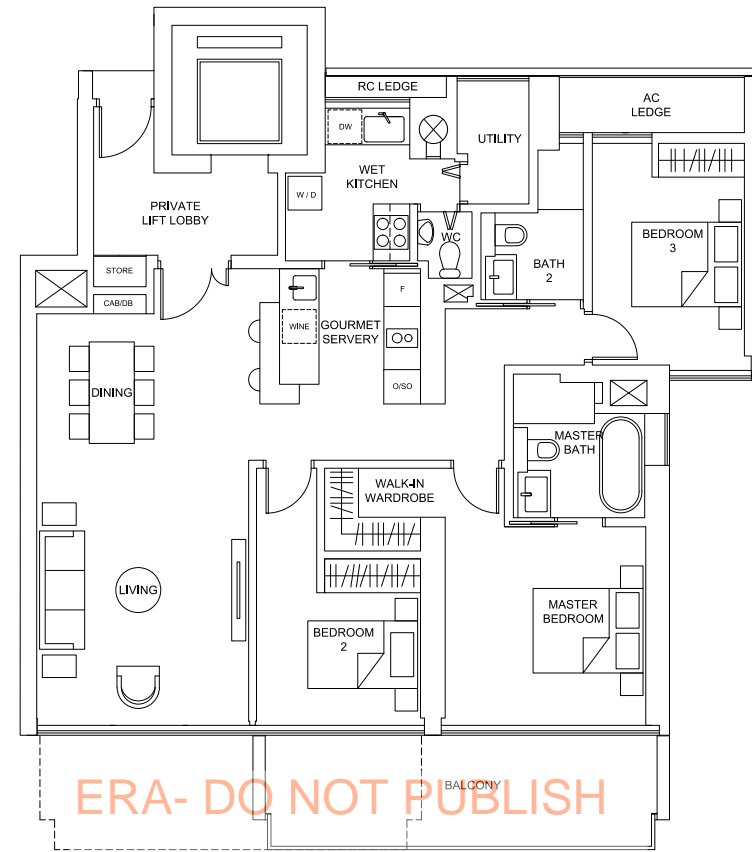

3-Bedroom

Type 3C

142 sq.m. / 1,528 sq.ft. to 143 sq.m. / 1,539 sq.ft.
(including balcony of 13 sq.m. / 140 sq.ft. to 14 sq.m. / 151 sq.ft.)

TABULATION

Unit	Balcony Area		Floor Area		Configuration
	sq.m.	sq.ft.	sq.m.	sq.ft.	
#06-15, #07-15, #08-15, #13-15, #14-15, #15-15, #16-15, #19-15, #20-15, #21-15, #22-15, #27-15, #28-15, #29-15	13	140	142	1,528	A
#04-15, #05-15, #09-15, #10-15, #11-15, #12-15, #17-15, #18-15, #23-15, #24-15, #25-15, #26-15, #30-15, #31-15, #32-15	14	151	143	1,539	B

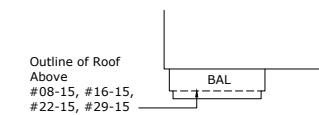
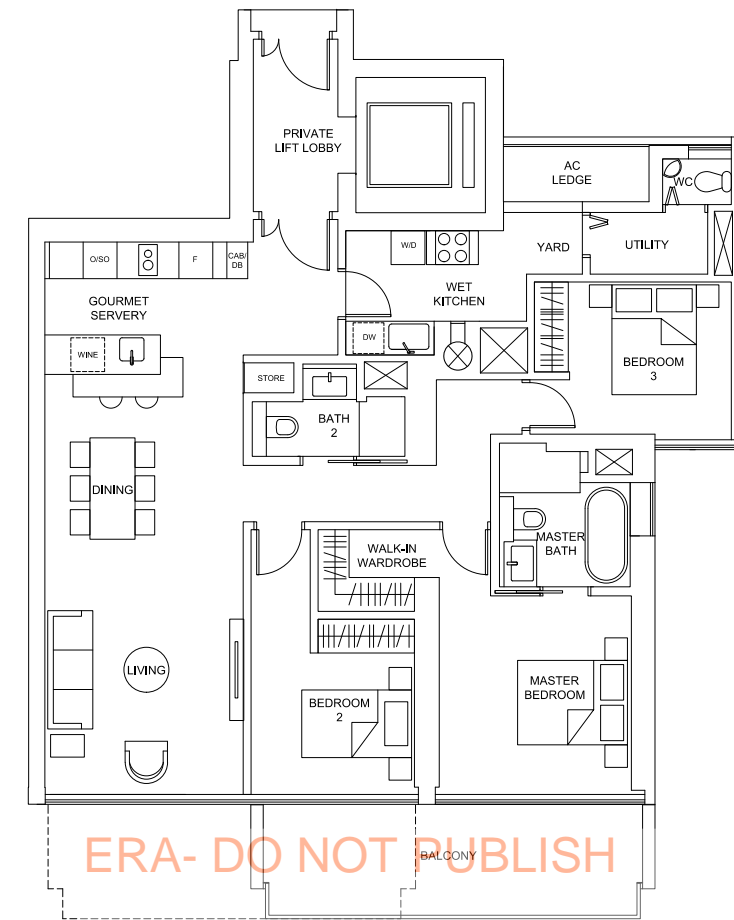
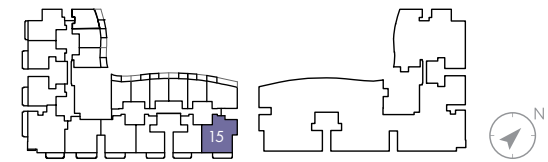

Balcony Configuration A

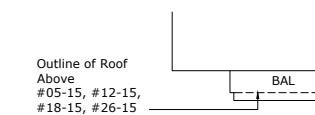

Balcony Configuration B

Type 3B

140 sq.m. / 1,507 sq.ft. to 141 sq.m. / 1,518 sq.ft.
(including balcony of 13 sq.m. / 140 sq.ft. to 14 sq.m. / 151 sq.ft.)

TABULATION

Unit	Balcony Area		Floor Area		Configuration
	sq.m.	sq.ft.	sq.m.	sq.ft.	
#07-18, #08-18, #09-18, #10-18, #14-18, #15-18, #16-18, #19-18, #20-18, #21-18, #22-18, #25-18, #26-18, #27-18, #28-18	13	140	140	1,507	A
#04-18, #05-18, #06-18, #11-18, #12-18, #13-18, #17-18, #18-18, #23-18, #24-18, #29-18, #30-18, #31-18	14	151	141	1,518	B

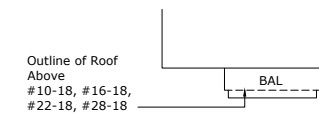
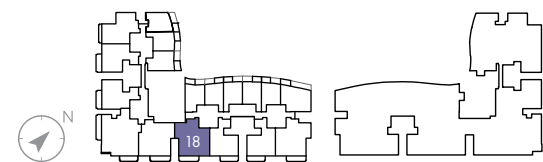

Balcony Configuration A

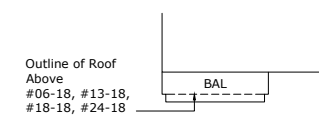

Balcony Configuration B

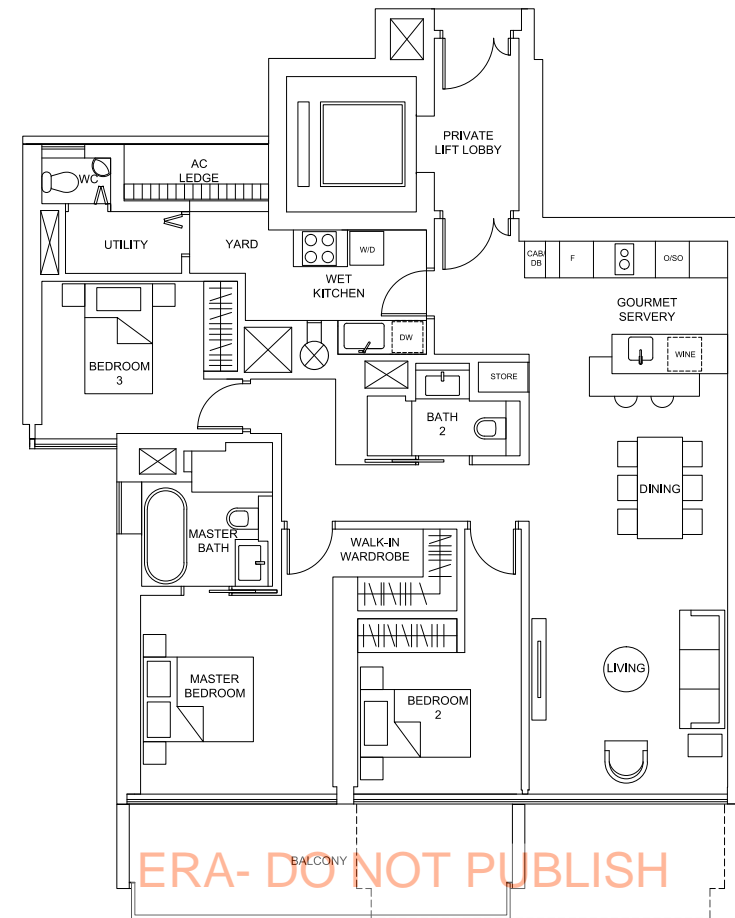

Type 4A

190 sq.m. / 2,045 sq.ft. to 209 sq.m. / 2,250 sq.ft.
(including balcony of 11 sq.m. / 118 sq.ft. to 30 sq.m. / 323 sq.ft.)

TABULATION

Unit	Balcony Area		Floor Area		Configuration
	sq.m.	sq.ft.	sq.m.	sq.ft.	
#08-08, #09-08, #10-08, #15-08, #16-08, #17-08, #21-08, #22-08, #27-08, #28-08	11	118	190	2,045	A
#23-08	18	194	197	2,121	B
#20-08, #26-08, #29-08	23	248	202	2,174	C
#04-08, #05-08, #06-08, #07-08, #11-08, #12-08, #13-08, #14-08, #18-08, #19-08, #24-08, #25-08, #30-08, #31-08, #32-08	30	323	209	2,250	D

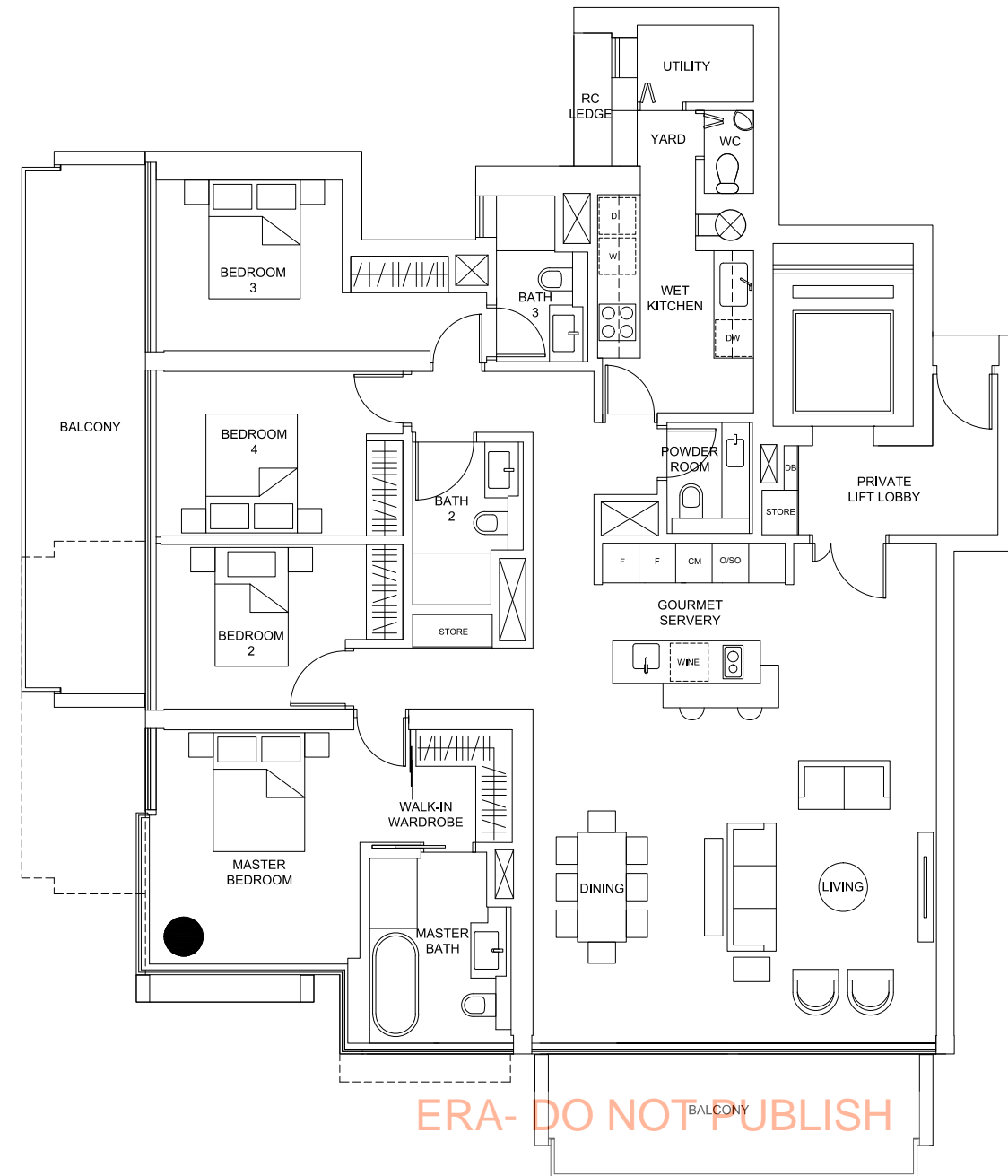
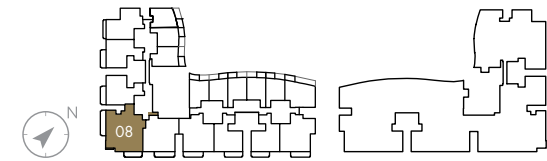

1. CEILING (FOR APARTMENT)

- Living, Dining, Private Lift Lobby, Gourmet Servery, All Bedrooms, Walk-In Wardrobe, Study, Utility and Store : Concrete slab with skim coat finish and/or plasterboard box-up/ceiling at designated areas with paint finish
- All Bathrooms, Powder Room, Wet Kitchen, WC and Yard : Moisture resistant plasterboard ceiling with paint finish
- Balcony : Concrete slab with skim coat and paint finish and/or moisture resistant plasterboard ceiling with paint finish and/or perforated metal panel ceiling

2. FINISHES

WALL (FOR APARTMENT)

- Living, Dining, Private Lift Lobby, Gourmet Servery, All Bedrooms, Walk-In Wardrobe, Study and Store : Skim coat and/or cement and sand plaster and/or dry wall with paint finish to false ceiling height and on exposed surfaces only
- All Bathrooms and Powder Room : Stone to false ceiling height and on exposed surfaces only
- Wet Kitchen, Yard, Utility and WC : Tiles and/or skim coat and/or cement and sand plaster and/or dry wall with paint finish to false ceiling height and on exposed surfaces only
- Balcony : Skim coat and/or cement and sand plaster with paint finish and/or perforated metal cladding and/or glass cladding

FLOOR (FOR APARTMENT)

- Living, Dining, Private Lift Lobby, Gourmet Servery and Study : Stone finish with timber skirting (except Type 1)
- Living, Dining, Gourmet Servery, Master Bedroom and Walk-In Wardrobe : Stone and/or timber finish with timber skirting (for Type 1 only)
- All Bedrooms and Walk-In Wardrobe : Timber finish with timber skirting (except Type 1)
- All Bathrooms and Powder Room : Stone finish
- Wet Kitchen, Yard, Utility, WC and Balcony : Tile finish with tile skirting and/or metal skirting
- Store : Cabinetry finish

3. WINDOWS

- Aluminium framed casement and/or sliding windows and/or fixed aluminium louvers (where applicable)
- Double and/or single glazing with clear/frosted glass (where applicable)

4. DOORS

- Main Entrance and Private Lift Lobby : Approved fire-rated timber door
- Balcony : Aluminium framed sliding door with clear glass
- All Bedrooms (except Type 1), All Bathrooms, Powder Room and Wet Kitchen : Timber door and/or sliding timber door (glass panel where applicable)
- Master Bedroom (for Type 1 only) : Timber door or slide and fold timber door
- Store : Cabinetry door(s) in laminated finish
- Walk-In Wardrobe : Frameless clear glass sliding door (for Type 4 only)
- Utility and WC : PVC bi-fold door (with fixed aluminium louvers above where applicable)

5. IRONMONGERY

Quality ironmongery to be provided to all doors

6. SANITARY WARES AND FITTINGS

- Master Bath**
- 1 stone vanity top complete with wash basin, basin mixer and vanity cabinet
 - 1 free-standing bath tub with floor-standing bath mixer set (for Types 3 and 4 only)
 - 1 hand towel holder
 - 1 towel rail
 - 1 shower cubicle complete with 1 overhead shower, 1 shower and mixer
 - 1 water closet
 - 1 paper roll holder
 - 1 robe hook
 - 1 mirror
- Common Bath**
- 1 vanity top complete with wash basin, basin mixer and vanity cabinet
 - 1 hand towel holder
 - 1 towel rail
 - 1 shower cubicle complete with 1 shower and mixer
 - 1 water closet
 - 1 paper roll holder
 - 1 robe hook
 - 1 mirror

Powder Room

- 1 vanity top complete with wash basin and basin mixer
- 1 towel rail
- 1 hand towel holder
- 1 water closet
- 1 paper roll holder
- 1 robe hook
- 1 mirror

WC

- 1 wash basin and tap
- 1 hand shower set
- 1 water closet
- 1 paper roll holder

7. ADDITIONAL ITEMS

a. Gourmet Servery

- Imported high and low kitchen cabinets with solid surface worktop, stainless steel sink and mixer
- Cooker hood and induction hob
- Breakfast Counter (except Type 1)
- Combi Microwave Oven (for Types 1 and 2 only)
- 1 no. Integrated Refrigerator/ Freezer (except Type 4)
- 2 no.s Integrated Refrigerator/Freezer (for Type 4 only)
- Washer cum Dryer (for Types 1 and 2 only)
- Under-counter Wine Chiller (for Types 3 and 4 only)
- Oven (for Types 3 and 4 only)
- Steam Oven (for Types 3 and 4 only)
- Coffee Machine (for Type 4 only)

b. Wet Kitchen

- Quality built-in high and low kitchen cabinets with solid surface worktop, stainless steel sink and mixer
- Cooker hood and cooker hob
- Dishwasher
- Washer
- Dryer

c. Wardrobes

- Quality wardrobe and/or walk-in wardrobe with pole system

d. Air-Conditioning

- Concealed split system air-conditioning to Private Lift Lobby, Living, Dining, Gourmet Servery and Study
- Wall-mounted split system air-conditioning to All Bedrooms (except Types 3 and 4 Master Bedroom)
- Concealed split system air-conditioning to Master Bedrooms (for Types 3 and 4 only)
- Accessory lot for A/C ledge (for Types 1B, 1E, 1H and 4A only)

e. Mechanical Ventilation

- Mechanical ventilation provided for Bathrooms, Powder Room and WC (where applicable)

f. Hot Water Supply

- Hot water supply to Gourmet Servery, Wet Kitchen, All Bathrooms and Powder Room

g. Water Heater

- Heat Recovery type Electric Storage Water Heater System (for Types 1 and 2 excluding Types 1B, 1E and 1H)
- Electrical Storage Water Heaters (for Types 1B, 1E and 1H only)
- Gas Water Heater (for Types 3 and 4 only)

h. Town Gas

- Town Gas supply to Wet Kitchen

i. Security System

- Audio Video Intercom between 2nd storey/ 3rd storey lift lobbies and apartment units
- Proximity card access system to lift lobbies and amenities where applicable
- CCTV to lift lobbies and at designated common areas where applicable
- Automatic car barrier system

j. Waste Disposal System

- Pneumatic refuse conveyance system with waste chutes provided at each residential level of each apartment unit

The specifications stated above are abbreviated. The Developer will provide intending purchasers with the relevant particulars, documents and information (including but not limited to the more detailed specifications of the relevant unit) in accordance with the requirements of Form 3 of the Housing Developers Rules ("PDI") and intending purchasers should therefore refer to such PDI, before paying the booking fee for a unit.